

## ***Christmas Bell Ornament***

This ornament is a simple hollowed bell, but has a clapper that moves. A two piece clapper and a couple of screw eyes allows the clapper free movement.

Form and hollowing is virtually identical to creating a long stem goblet.

by Ed Malesky



Start the bell with a blank about 4" by 2 1/4". Mark where you want the top of the bell to be, where it transitions to the handle.

Form the bell. Leave a little thick at the base so there is enough strength to hollow out the bell.

Drill a hole to the depth you want to hollow.

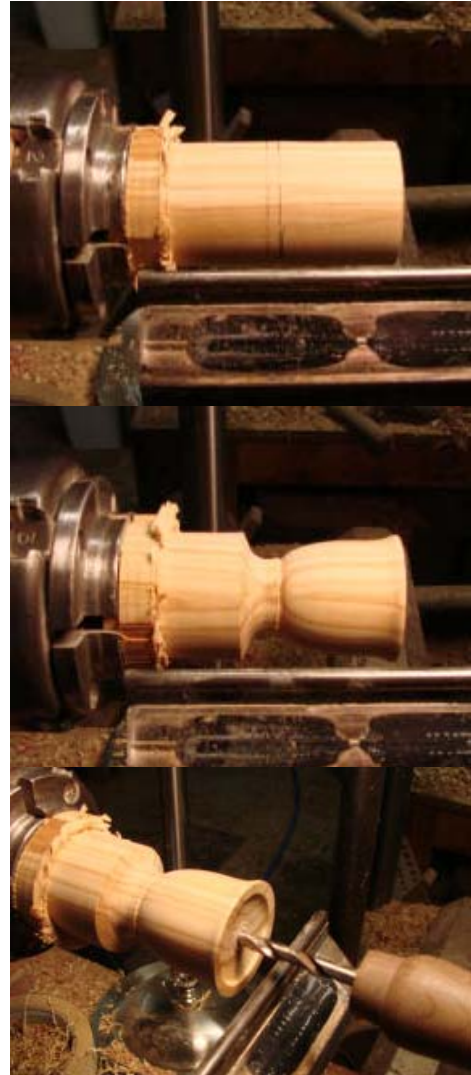

Hollow the bell using your favorite hollowing tool. Get the bell fairly thin, 1/8" or less, to reduce the weight of the ornament. Shear scrape the inside to the final wall thickness, then sand both the inside and outside of the bell.



Drill a 5/32" hole in the inside of the bell at the top. This will be the mortise for the clapper tenon.



Then return to the outside and finish the outside of the bell and the handle, then part off.

Then begin on the clapper. I generally use a contrasting wood. The clapper is two pieces; a button with a tenon that fits into the hole you drilled in the bell and a clapper. The two pieces are joined by connecting two screw eyes.



The blank only needs to be about 3/8" by 2".

Form a small tenon on the end 5/32" in diameter. You can test fit against another piece of wood you've drilled a 5/32" hole in.

Then form the button. Round over the top a little since the bell will not be flat at the top where you hollowed. Then part off and drill a small hole for the screw eye.



With the rest of the blank, make the clapper. Estimate the length you will need based on the distance from the top of the inside of the bell to the bottom.

Account for the button and two screw eyes which will be about 3/8" and decide if you want the clapper to extend a little below the bell or to be totally enclosed in the bell.

Sand and use a skew on it's side to make a small divot in the top end of the clapper stem to facilitate drilling a hole for the screw eye.

Open the screw eye on the button and slip it through the screw eye on the clapper stem. You might want to leave the top of the clapper stem a little thicker than the rest so that the screw eye doesn't split the stem.

Close the screw eye and you're set to glue the clapper into the bell.

Add a drop of CA into the mortise hole in the bell and using a needle nose pliers or tweezers, grasp the screw eye on the button and push the tenon into the hole.

Add another screw eye to the top of the bell handle and you're set to hang on the tree.

One modification is that you can do the bell handle out of a contrasting piece of wood. Just put a 5/16" tenon on the end of it and when you drill the hole for the clapper tenon, make the hole extra deep, so when you part off the bell, you can add the handle to the hole.

